

**PLAN - 368' UNIT 6**  
N.T.S.  
Sta. 296+40 to Sta. 300+08 (One Unit Required)

**BAR LIST PER 368' UNIT**

Sta. 296+40 to Sta. 300+08			
Mark	No. Req'd.	Length	Dia. Pin
S401E	1,100	39'-2"	Str.
S501E	316	43'-6"	3"
S601E	634	42'-10"	Str.
S701E	632	12'-10"	6"
S702E	159	46'-0"	Str.
P401E	722	6'-4"	2"
P402E	722	5'-8"	2"
P403E	248	5'-11"	2"
P404E	248	3'-1"	2"
P405E	96	5'-2"	Str.
P406E	226	13'-2"	Str.
P601E	155	13'-2"	Str.
D401	128	9'-5"	2"
D402	64	10'-4"	2"
D403	96	11'-2"	2"
D601	192	6'-9"	Str.
D602	72	7'-4"	Str.
D603	48	20'-7"	Str.

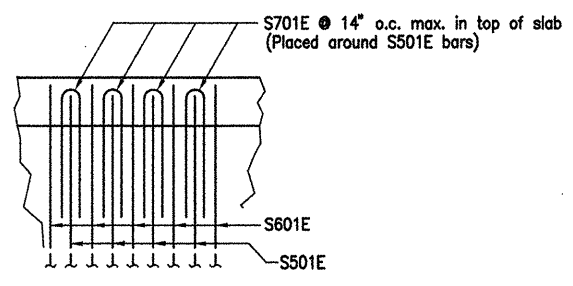
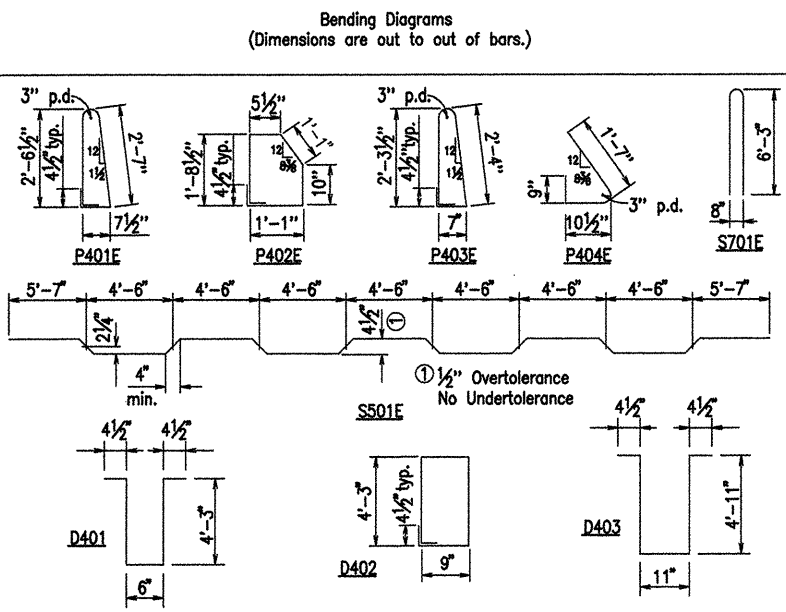

**DETAIL A**  
N.T.S.

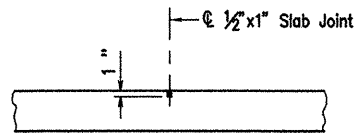

Use 1/2" X 1" Type 3, 4 or 6 Joint Sealer. See Subsection 501.02(h) and 501.05(j). Backer rod shall not be installed. Joint Sealer shall be measured and paid for as Class S(AE) Concrete-Bridge. Slab joints shall extend to the outside edge of the deck slab. Slab joints shall be installed before the parapet railing is poured. If slab joints are to be sawed, they shall be sawed as soon as the concrete has sufficiently set to allow sawing of the joint without damage to the slab. Slab joints shall be placed at all pouring sequence construction joints and required slab joint locations.

**SLAB JOINT DETAIL**  
N.T.S.

NOTE: Pours with the same number may be placed simultaneously or separately. All Pours (1) must be placed before Pours (2) can be placed. 48 hours shall elapse between the end of a pour and the start of the next pour. 72 hours shall elapse between the end of a pour and the start of an adjacent pour. Any railing pours made before the entire slab unit has been placed must be approved by the Bridge Engineer. Concrete in bridge superstructure shall be consolidated for the entire pour before any concrete has taken its initial set. This may require the use of a retarding agent. The Contractor must obtain approval from the Bridge Engineer for any deviations from the pouring sequence.

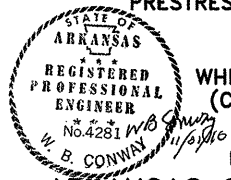

**ALTERNATE NO. 1**

**DETAILS OF 284', 330' & 368' CONT. PRESTRESSED CONCRETE GIRDER UNITS (SHEET 14 OF 19)**

**WHITE RIVER STR. & APPRS. (CLARENDON) (PH III) (F) MONROE COUNTY**

**ROUTE 79 SEC. 13 ARKANSAS STATE HIGHWAY COMMISSION LITTLE ROCK, ARK.**

**Engstrom/Modjeski and Masters, Inc.**

DRAWN BY: CJA DATE: Nov. 07 FILENAME: b11039512\_s12  
CHECKED BY: YO DATE: Nov. 01 SCALE: 1/6" = 1'-0"  
DESIGNED BY: GPT DATE: Nov. 01

Revised Bar List by HJE/MM  
GPT- 11-1-10

BRIDGE ENGINEER

BRIDGE NO. 06830 DRAWING NO. 47074